

FIG. 7.11 PARTS DIAGRAM FOR "COMMON" COMPONENTS

NOTE : WHERE ALTERNATIVE REFERENCES ARE GIVEN ENSURE THAT THE CORRECT PARTS LIST FOR THE MACHINE IS REFERRED TO.

KEY TO REFERENCES :

- C - USED ON ALL MACHINES
 - S - USED ON RS1000 MACHINES (1000mm WIDE DRUM)
 - M - USED ON RS400 MACHINES (450mm WIDE DRUM)
 - P - USED ON PERFORATED DRUM MACHINES
 - W - USED ON WEDGEWIRE DRUM MACHINES
 - B - PROPRIETARY ITEMS
- REFER TO SEPARATE LISTS FOR DRUMS & GEARMOTORS

RS1000 Mark 3

AMERTRONICS MONROE/SUBURY, FD 1712

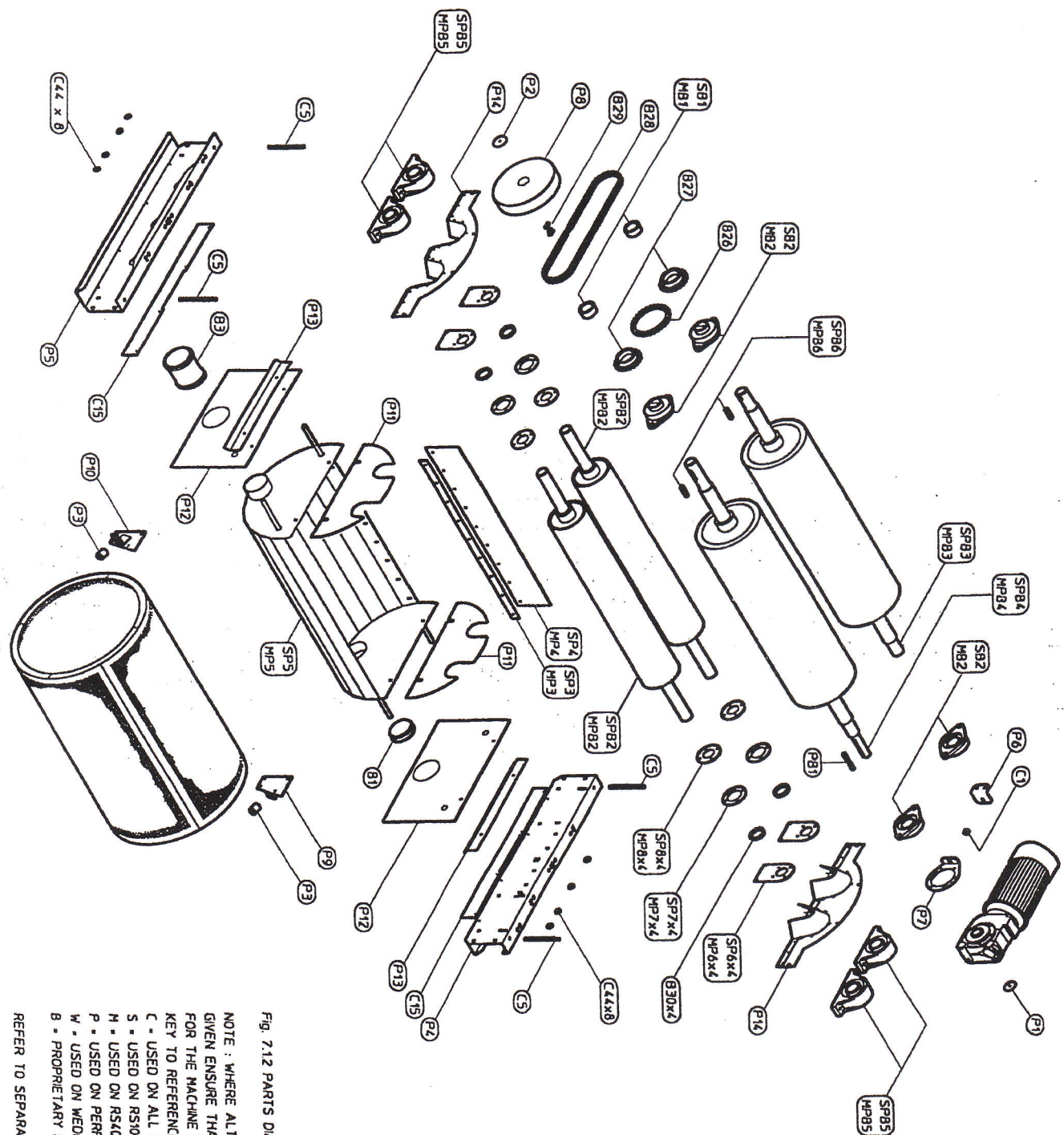

Fig. 7.12 PARTS DIAGRAM FOR 'PERFORATED' COMPONENTS

NOTE : WHERE ALTERNATIVE REFERENCES ARE GIVEN ENSURE THAT THE CORRECT PARTS LIST FOR THE MACHINE IS REFERRED TO .

KEY TO REFERENCES :

- C - USED ON ALL MACHINES
- S - USED ON RS1000 MACHINES (1000mm WIDE DRUM)
- M - USED ON RS400 MACHINES (450mm WIDE DRUM)
- P - USED ON PERFORATED DRUM MACHINES
- W - USED ON WEDGEWIRE DRUM MACHINES
- B - PROPRIETARY ITEMS

REFER TO SEPARATE LISTS FOR DRUMS & GEARROTORS
Page 31